



1500i

What to specify...

1. Model

2. Voltage

3. Volume or Vacuum

4. Pre-filter

5. Main filter

6. Connection Kit

7. Power Lead

8. Interfacing Kit

1	2	3	1500i	
Voltage			230V ±10%	120V ±10%
Volume Control			0LX1510D	0LX1511D
Vacuum Control			021820iD	021821iD
Wattage			3.45 kW	3.45 kW
Frequency			50Hz / 60 Hz	50Hz / 60 Hz
Cabinet height (inc castors)			1400 mm	1400 mm
Cabinet width (not inc hose)			725 mm	725 mm
Cabinet depth (not inc hose)			726 mm	726 mm
Cabinet weight			150 Kg	150 Kg
Sound Rating (dBA)			59	59
Airflow m³/hr			1700	1700
Vacuum (kPa)			4.77	4.77

4 **Labyrinth Pre-filter**



One supplied - See page 19-20

5 **Main Filter**



One supplied - See page 21-22 for your application

6 **Connection Hose Kit**

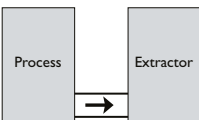

One supplied - See page 23-25 to suit your system

7 **Power Cable**

5M Fixed power cable, no plug fitted.

8 **Machine Interfacing (Optional)**



See page 27-29 to match your system

Allows the Purex system to interface with a piece of equipment connected to it.

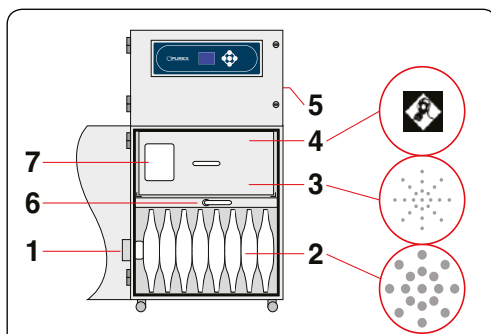

- Legend:**
- 1) Air inlet - 150mm safe seal.
 - 2) Pre-filter.
 - 3) Main Filter (HEPA location). †
 - 4) Main Filter (Carbon location). †
 - 5) Clean air returned to workplace.
 - 6) Filter locking handle.
 - 7) Filter identification label.

All machines are mounted on four castors for increased mobility.

† Standard Filter Only

Digital Control System

A dedicated control, monitoring and display system unique to Purex fume extractors. All functions are fully automatic, all the user has to do is set the appropriate airflow on installation. The features of this system are designed to:

- Lower energy consumption by using variable speed motors and automatic flow control.
- Increase filter life by using the optimal extraction rate.
- Further protect people by constantly monitoring exhaust emissions.
- Interface with other equipment e.g. a laser.
- Maintain a constant extraction rate to prevent fume escape or damage to equipment.

System Features...

- Automatic electronic flow control - maintains a constant extraction rate even as the filter blocks
- Adjustable airflow
- Clear and informative graphic display
- Gas and particle sensors on the exhaust
- Low capital and running costs
- Quick change patented Labyrinth pre-filters deliver longer filter life
- Submicronic (HEPA) filtration removes 99.997% of particles down to 0.3 microns
- Activated carbon filtration removes harmful gas
- Simple to install and quiet in operation
- Easy to relocate and precision made from stainless steel
- High performance brushless motors

Includes:

- 1 x Main filter
- 1 x Labyrinth pre-filter
- 1 x Power cable (no plug)

Accessories

Please see the accessories brochure.