

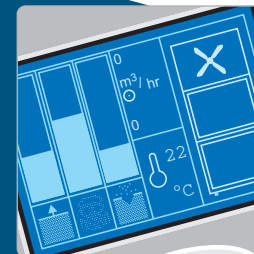

## Purex Fume Extraction Systems

Built by Purex for Epilog Lasers

*Protecting People and the Environment with Innovative Technology.....*



# Purex Fume Extractors - The ideal partner for Epilog Lasers



**Many unique features help ensure your product quality and production rates remain high and the operator is protected from harmful fumes.**

## Plug and Play

All units are plug and play and are mounted on castors to make them easy to manoeuvre. Many machines can be installed in minutes.

## Low Cost of Ownership

Patented filter designs deliver low cost of ownership compared to other extraction systems.

## Fully Adjustable

Adjustable speed control allows the operator to achieve the optimum extraction rate for the engraving. Automatic closed loop flow control keeps it there.

## Easy to Install

No need to put holes in walls or roofs to vent fume outside your building. Unobtrusive and fits easily into small areas.

## Quick Change Filters

All filters can easily be changed in seconds without mess or disruption. The extractor returns clean, purified air to the workplace.

## Comply with Regulations

Helps to ensure compliance with relevant national and international health & safety and environmental regulations.

## Wide Variety of Materials

Filters fume from many materials including organic materials, metals and plastics.

## Keep your laser running at peak output...

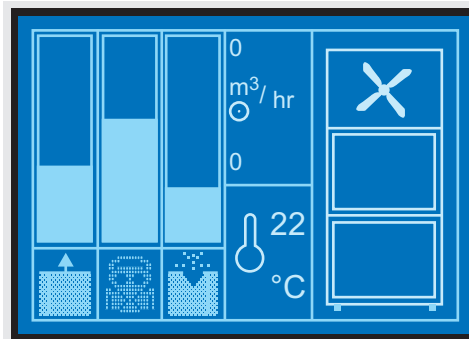
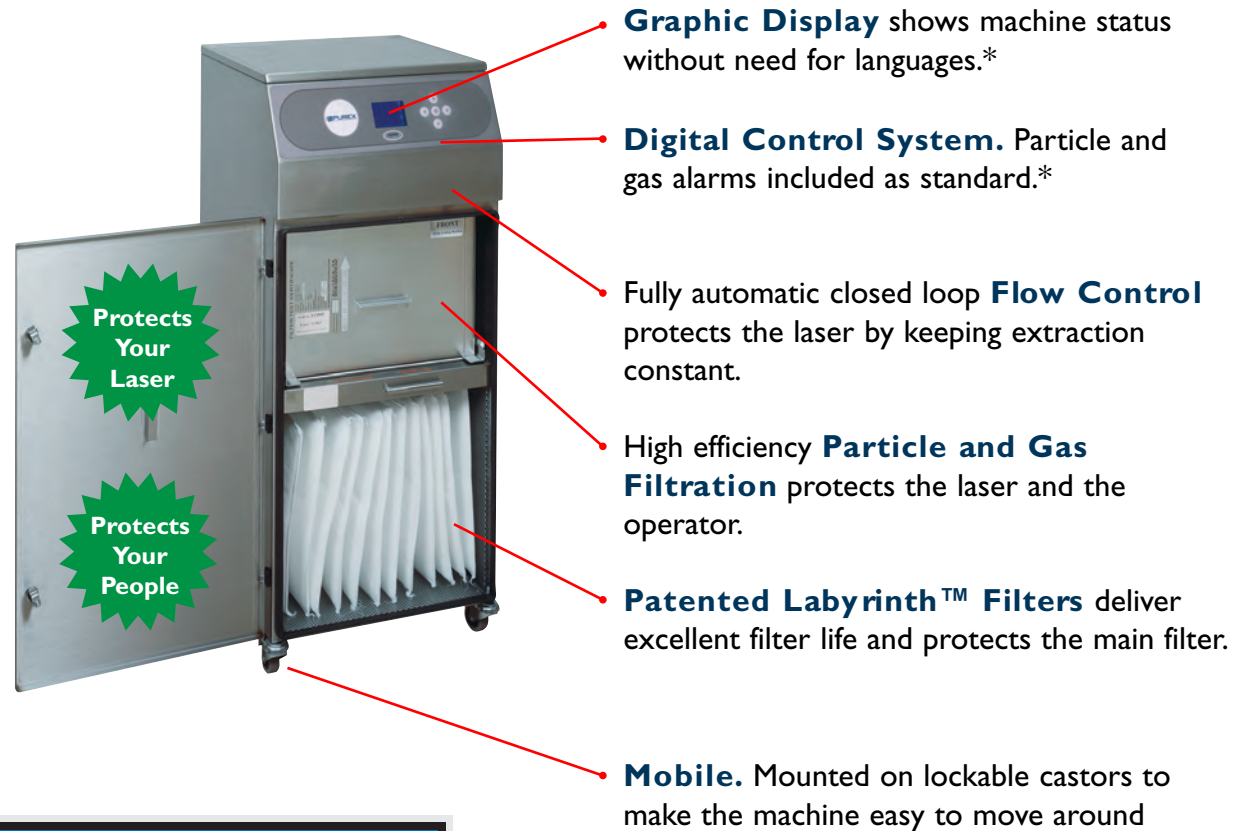

**Simple to use - Fully automatic**

\* Digital models only

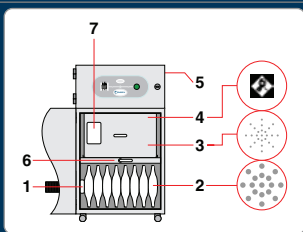

**Alpha 200** built for Mini 18, Fibremark G1 & Zing p4

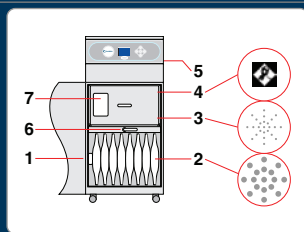

**LasereX 400i** built for Helix & Fibremark p9

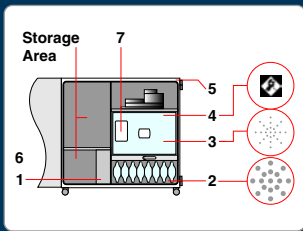

**Xbase 200** built for Mini 18, Fibremark G1 & Zing p5

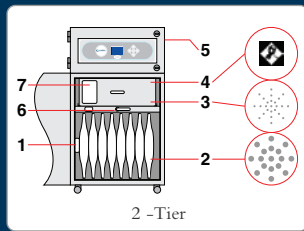

**LasereX 800i** built for 36EXT ≤ 60W p10

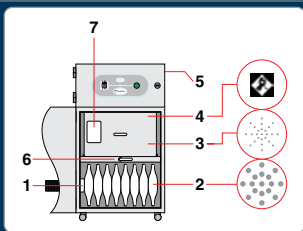

**Alpha 400** built for Mini 24, Fibremark G1 & Zing p6

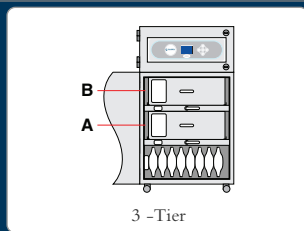

**LasereX 800i** heavy acrylic engraving (Except 36EXT > 60W) p11

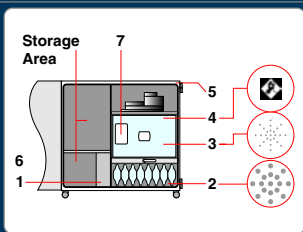

**Xbase 400** built for Mini 24, Fibremark G1 & Zing p7

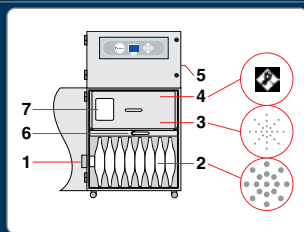

**LasereX 1500i** built for 36EXT > 60W p12

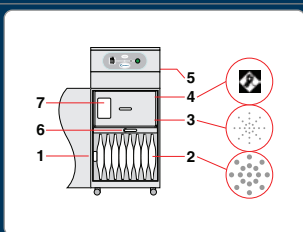

**Alpha 400 i** built for Helix & Fibremark p8

**Legend:**

- 1) Air inlet. 2) Labyrinth™ prefilter bag. 3) Main Filter (HEPA location). 4) Main Filter (Carbon location). 5) Clean air returned to workplace. 6) Filter locking handle. 7) Filter identification label.

**Note for 800i x3:**

Same as 800i x 2 except. A) Individual HEPA filter B) Individual Carbon filter

# Alpha 200

Built for

Mini I8, Fibremark G1, Zing\*

\*A larger model may be considered when smaller lasers are used continuously or when lasing certain problematic materials. Contact your supplier for advice.

## Machines



**Voltage: 230V**  
Code: 0AL2102E

**Voltage: 120V**  
Code: 0AL2103E

Supplied with: 1 x Main Filter + 1 x Labyrinth Pre-Filter

## Options



**HEPA / Twin Chemical Filter**  
Code: 113579



**Labyrinth™ pre-filter F8/F9**  
Code: 111095

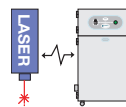

**Laser Interfacing Pack:**  
Code: 100269

A spare filter set is recommended



## Features & Benefits

- Protects the operator from harmful fumes.
- Prevents fumes damaging the laser.
- To further protect the laser the automatic flow control system maintains a constant extraction rate throughout the life of the filter.
- Safely recirculates air so no holes in walls or ceilings are required for external ducting.
- Low capital and running costs with minimal installation required.
- Whisper Stream™ system keeps noise levels to a minimum.
- VariColour™ warning system fitted as standard indicates when new filters are required.
- Patented Labyrinth™ pre filter protects the HEPA filter and delivers vastly extended filter life.
- Submicronic HEPA particle filtration - 99.997% of particles captured at 0.3 micron.
- Specially formulated carbon layer filters gas from the process.
- All filters deliver excellent filter life.
- Filters can be changed in seconds.
- Easy to move around on castors.

## Specification

Voltage	230V ±10%	120V ±10%
Part number	0AL2102E	0AL2103E
Wattage	0.135 kW	0.107 kW
Sound rating	45 dBA	45 dBA
Max flowrate	200 m <sup>3</sup> /hr	125 cf/m
Frequency	50 Hz / 60 Hz	
Cabinet height (inc. castors)	885 mm • 35"	
Cabinet width (not inc. hose)	465 mm • 18 1/4"	
Cabinet depth (not inc. hose)	465 mm • 18 1/4"	
Cabinet weight (inc. filters)	41 Kg • 90 lbs	

### Controls

- Illuminated ON/OFF switch
- Filter blocked LED
- Speed Control

### Construction

All machines are constructed of corrosion resistant stainless steel

### Blowers

Continuously rated, powerful brushless blowers

## Connection Kit

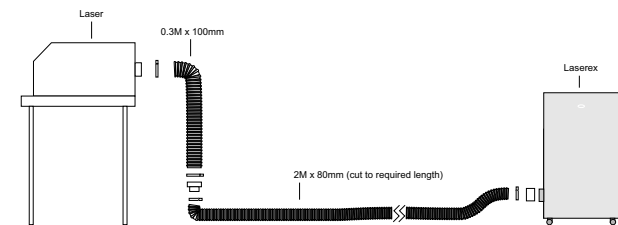

Code: 120288

1	80mm female coupling
2	70mm to 90mm hose clips
1	2M x 80mm flexible hose
1	100mm to 80mm reducer
1	0.3M x 100mm flexible hose
2	90mm to 120mm hose clips

Metal Kits Available. Contact Purex for Details

# Xbase 200

Built for

Mini I8, Fibremark GI, Zing\*

\*A larger model may be considered when smaller lasers are used continuously or when lasing certain problematic materials. Contact your supplier for advice.

## Machines



**Voltage: 230V**  
Code: 0AL2110E

**Voltage: 120V**  
Code: 0AL2111E

Supplied with: 1 x Main Filter + 1 x Labyrinth Pre-Filter

## Options



**HEPA / Twin Chemical Filter**  
Code: 110545

**HEPA/CSA Chemical Filter \*\***  
Code: 113585



**Labyrinth™ pre-filter F8/F9**  
Code: 111108

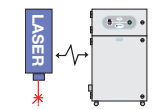

**Laser Interfacing Pack:**  
Code: 100269



A spare filter set is recommended

\*\* Heavy duty filter for materials such as natural rubber.

## Features & Benefits

- The Laser can sit on top of the machine so no need to buy a separate stand.
- Protects the operator from harmful fumes.
- Prevents fumes damaging the laser.
- To further protect the laser the automatic flow control system maintains a constant extraction rate throughout the life of the filter.
- Safely recirculates air so no holes in walls or ceilings are required for external ducting.
- Low capital and running costs with minimal installation required.
- Whisper Stream™ system keeps noise levels to a minimum.
- VariColour™ warning system fitted as standard indicates when new filters are required.
- Patented Labyrinth™ pre filter protects the HEPA filter and delivers vastly extended filter life.
- Submicronic HEPA particle filtration - 99.997% of particles captured at 0.3 micron.
- Specially formulated carbon layer filters gas from the process.
- All filters deliver excellent filter life.
- Filters can be changed in seconds.
- Easy to move around on castors.

## Specification

Voltage	230V ±10%	120V ±10%
Part number	0AL2110E	0AL2111E
Wattage	0.135 kW	0.107 kW
Sound rating	45 dBA	45 dBA
Max flowrate	200 m <sup>3</sup> /hr	125 cf/m
Frequency	50 Hz / 60 Hz	
Cabinet height (inc. castors)	705 mm • 27 3/4"	
Cabinet width (not inc. hose)	700 mm • 27 1/2"	
Cabinet depth (not inc. hose)	640 mm • 25 1/4"	
Cabinet weight (inc. filters)	63.5 Kg • 140 lbs	

### Controls

- Illuminated ON/OFF switch
- Filter blocked LED
- Speed Control

### Construction

All machines are constructed of corrosion resistant stainless steel

### Blowers

Continuously rated, powerful brushless blowers

## Connection Kit

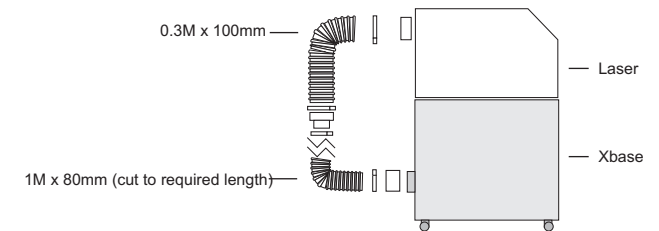

Code: 120292

1	80mm female coupling
2	70mm to 90mm hose clips
1	1M x 80mm flexible hose
1	100mm to 80mm reducer
1	0.3M x 100mm flexible hose
2	90mm to 120mm hose clips

Metal Kits Available. Contact Purex for Details

# Alpha 400

Built for

Mini 24, Fibremark GI, Zing\*

\*A larger model may be considered when smaller lasers are used continuously or when lasing certain problematic materials. Contact your supplier for advice.

## Machines



**Voltage: 230V**  
Code: 0AL4220E

**Voltage: 120V**  
Code: 0AL4230E

Supplied with: 1 x Main Filter + 1 x Labyrinth Pre-Filter

## Options



**HEPA / Twin Chemical Filter**  
Code: 113579



**Labyrinth™ pre-filter F8/F9**  
Code: 111095

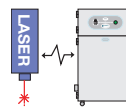

**Laser Interfacing Pack:**  
Code: 100269

A spare filter set is recommended



## Features & Benefits

- Protects the operator from harmful fumes.
- Prevents fumes damaging the laser.
- To further protect the laser the automatic flow control system maintains a constant extraction rate throughout the life of the filter.
- Safely recirculates air so no holes in walls or ceilings are required for external ducting.
- Low capital and running costs with minimal installation required.
- Whisper Stream™ system keeps noise levels to a minimum.
- VariColour™ warning system fitted as standard indicates when new filters are required.
- Patented Labyrinth™ pre filter protects the HEPA filter and delivers vastly extended filter life.
- Submicronic HEPA particle filtration - 99.997% of particles captured at 0.3 micron.
- Specially formulated carbon layer filters gas from the process.
- All filters deliver excellent filter life.
- Filters can be changed in seconds.
- Easy to move around on castors.

## Specification

Voltage	230V ±10%	120V ±10%
Part number	0AL4220E	0AL4230E
Wattage	0.240 kW	0.235 kW
Sound rating	45 dBA	45 dBA
Max flowrate	400 m <sup>3</sup> /hr	235 cf/m
Frequency	50 Hz / 60 Hz	
Cabinet height (inc. castors)	885 mm • 35"	
Cabinet width (not inc. hose)	465 mm • 18 1/4"	
Cabinet depth (not inc. hose)	465 mm • 18 1/4"	
Cabinet weight (inc. filters)	41 Kg • 90 lbs	

### Controls

- Illuminated ON/OFF switch
- Filter blocked LED
- Speed Control

### Construction

All machines are constructed of corrosion resistant stainless steel

### Blowers

Continuously rated, powerful brushless blowers

## Connection Kit

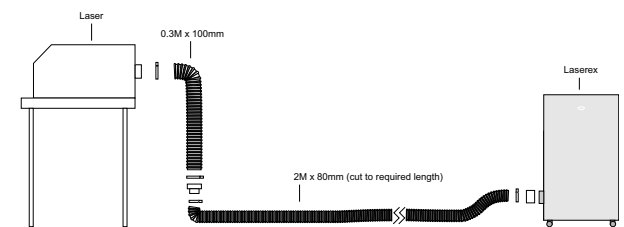

Code: 120288

1	80mm female coupling
2	70mm to 90mm hose clips
1	2M x 80mm flexible hose
1	100mm to 80mm reducer
1	0.3M x 100mm flexible hose
2	90mm to 120mm hose clips

# Xbase 400

Built for

Mini 24, Fibremark GI, Zing\*

\*A larger model may be considered when smaller lasers are used continuously or when lasing certain problematic materials. Contact your supplier for advice.

## Machines



**Voltage: 230V**  
Code: 0AL4108E

**Voltage: 120V**  
Code: 0AL4109E

Supplied with: 1 x Main Filter + 1 x Labyrinth Pre-Filter

## Options



**HEPA / Twin Chemical Filter**  
Code: 110545

**HEPA/CSA Chemical Filter \*\***  
Code: 113585



**Labyrinth™ pre-filter F8/F9**  
Code: 111108

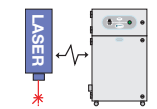

**Laser Interfacing Pack:**  
Code: 100269



A spare filter set is recommended

\*\* Heavy duty filter for materials such as natural rubber.

## Features & Benefits

- The Laser can sit on top of the machine so no need to buy a separate stand.
- Protects the operator from harmful fumes.
- Prevents fumes damaging the laser.
- To further protect the laser the automatic flow control system maintains a constant extraction rate throughout the life of the filter.
- Safely recirculates air so no holes in walls or ceilings are required for external ducting.
- Low capital and running costs with minimal installation required.
- Whisper Stream™ system keeps noise levels to a minimum.
- VariColour™ warning system fitted as standard indicates when new filters are required.
- Patented Labyrinth™ pre filter protects the HEPA filter and delivers vastly extended filter life.
- Submicronic HEPA particle filtration - 99.997% of particles captured at 0.3 micron.
- Specially formulated carbon layer filters gas from the process.
- All filters deliver excellent filter life.
- Filters can be changed in seconds.
- Easy to move around on castors.

## Specification

Voltage	230V ±10%	120V ±10%
Part number	0AL4108E	0AL4109E
Wattage	0.240 kW	0.235 kW
Sound rating	45 dBA	45 dBA
Max flowrate	400 m <sup>3</sup> /hr	235 cf/m
Frequency	50 Hz / 60 Hz	
Cabinet height (inc. castors)	705 mm • 27 3/4"	
Cabinet width (not inc. hose)	700 mm • 27 1/2"	
Cabinet depth (not inc. hose)	640 mm • 25 1/4"	
Cabinet weight (inc. filters)	63.5 Kg • 140 lbs	

### Controls

- Illuminated ON/OFF switch
- Filter blocked LED
- Speed Control

### Construction

All machines are constructed of corrosion resistant stainless steel

### Blowers

Continuously rated, powerful brushless blowers

## Connection Kit

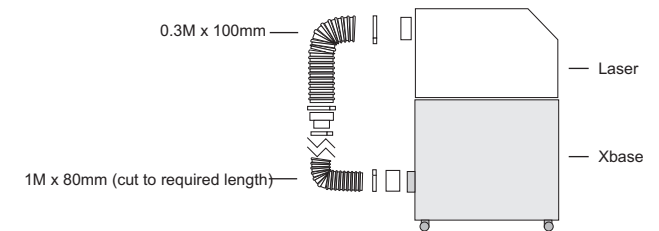

Code: 120292

1	80mm female coupling
2	70mm to 90mm hose clips
1	1M x 80mm flexible hose
1	100mm to 80mm reducer
1	0.3M x 100mm flexible hose
2	90mm to 120mm hose clips

Metal Kits Available. Contact Purex for Details

# Alpha 400i

Built for

Helix, Fibremark\*

\*A larger model may be considered when smaller lasers are used continuously or when lasing certain problematic materials. Contact your supplier for advice.

## Machines



**Voltage: 230V**  
Code: 0AL4113E

**Voltage: 120V**  
Code: 0AL4114E

Supplied with: 1 x Main Filter + 1 x Labyrinth Pre-Filter

## Options



**HEPA / Twin Chemical Filter**  
Code: 113579



**Labyrinth™ pre-filter F8/F9**  
Code: 111097

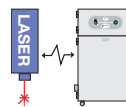

**Laser Interfacing Pack:**  
Code: 100269

A spare filter set is recommended



## Features & Benefits

- Protects the operator from harmful fumes.
- Prevents fumes damaging the laser.
- To further protect the laser the automatic flow control system maintains a constant extraction rate throughout the life of the filter.
- Safely recirculates air so no holes in walls or ceilings are required for external ducting.
- Low capital and running costs with minimal installation required.
- Whisper Stream™ system keeps noise levels to a minimum.
- VariColour™ warning system fitted as standard indicates when new filters are required.
- Patented Labyrinth™ pre filter protects the HEPA filter and delivers vastly extended filter life.
- Submicronic HEPA particle filtration - 99.997% of particles captured at 0.3 micron.
- Specially formulated carbon layer filters gas from the process.
- All filters deliver excellent filter life.
- Filters can be changed in seconds.
- Easy to move around on castors.

## Specification

Voltage	230V ±10%	120V ±10%
Part number	0AL4113E	0AL4114E
Wattage	0.240 kW	0.235 kW
Sound rating	45 dBA	45 dBA
Max flowrate	400 m <sup>3</sup> /hr	235 cf/m
Frequency	50 Hz / 60 Hz	
Cabinet height (inc. castors)	1070 mm • 42"	
Cabinet width (not inc. hose)	455 mm • 18"	
Cabinet depth (not inc. hose)	480 mm • 19"	
Cabinet weight (inc. filters)	55 Kg • 121 lbs	

### Controls

- Illuminated ON/OFF switch
- Filter blocked LED
- Speed Control

### Construction

All machines are constructed of corrosion resistant stainless steel

### Blowers

Continuously rated, powerful brushless blowers

## Connection Kit

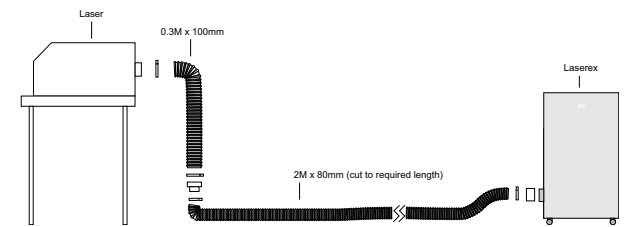

Code: 120288

1	80mm female coupling
2	70mm to 90mm hose clips
1	2M x 80mm flexible hose
1	100mm to 80mm reducer
1	0.3M x 100mm flexible hose
2	90mm to 120mm hose clips

# LasereX 400i

Built for

Helix, Fibremark\*

\*A larger model may be considered when smaller lasers are used continuously or when lasing certain problematic materials. Contact your supplier for advice.

## Machines



**Voltage: 230V**  
Code: 0LX4080DE

**Voltage: 120V**  
Code: 0LX4090DE

Supplied with: 1 x Main Filter + 1 x Labyrinth Pre-Filter

## Options



**HEPA / Twin Chemical Filter**  
Code: 113579



**Labyrinth™ pre-filter F8/F9**  
Code: 111097

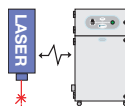

**Laser Interfacing Pack:**  
Code: 100269

A spare filter set is recommended



## Features & Benefits

- Protects the operator from harmful fumes.
- Prevents fumes damaging the laser.
- To further protect the laser the automatic flow control system maintains a constant extraction rate throughout the life of the filter.
- Safely recirculates air so no holes in walls or ceilings are required for external ducting.
- Low capital and running costs with minimal installation required.
- Patented Labyrinth™ pre filter protects the HEPA filter and delivers vastly extended filter life.
- Submicronic HEPA particle filtration - 99.997% of particles captured at 0.3 micron.
- Specially formulated carbon layer filters gas from the process.
- All filters deliver excellent filter life.
- Filters can be changed in seconds.
- Digital Control System with Graphic Display.
- Gas and Particle sensors.
- Easy to move around on castors.
- Small footprint - easily installed in minutes.

## Specification

Voltage	230V ±10%	120V ±10%
Part number	0AL4080DE	0AL4090DE
Wattage	1.2 kW	1.1 kW
Sound rating	52 dBA	55 dBA
Max flowrate	460 m <sup>3</sup> /hr	270 cf/m
Frequency	50 Hz / 60 Hz	
Cabinet height (inc. castors)	1070 mm • 42"	
Cabinet width (not inc. hose)	455 mm • 18"	
Cabinet depth (not inc. hose)	480 mm • 19"	
Cabinet weight (inc. filters)	55 Kg • 121 lbs	

### Controls

- Graphic Display
- Gas and Particle Sensors
- Filter Blocked Warning
- Motor Run and Temperature Sensors
- Realtime airflow display.

### Construction

All machines are constructed of corrosion resistant stainless steel

### Blowers

Continuously rated, powerful brushless blowers

## Connection Kit

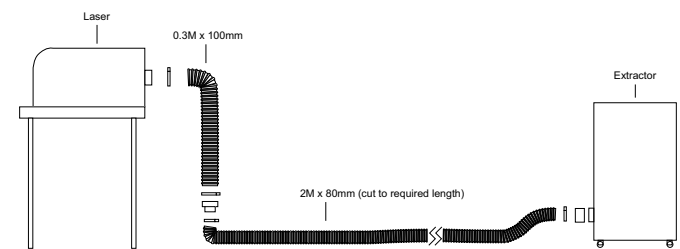

Code: 120288

1	80mm female coupling
2	70mm to 90mm hose clips
1	2M x 80mm flexible hose
1	100mm to 80mm reducer
1	0.3M x 100mm flexible hose
2	90mm to 120mm hose clips

Metal Kits Available. Contact Purex for Details

# LasereX 800i 2-Tier

Built for

36EXT 60W\*

The 800i is a heavy duty machine and is used where large quantities of particulate are produced i.e. lasing rubber.

## Machines



**Voltage: 230V**  
Code: 080620DE

**Voltage: 120V**  
Code: 080625DE

Supplied with: 1 x Main Filter + 1 x Labyrinth Pre-Filter

## Options



**HEPA / Twin Chemical Filter**  
Code: 113660



**Labyrinth™ pre-filter F8/F9**  
Code: 111004

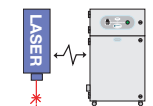

**Laser Interfacing Pack:**  
Code: 100269

A spare filter set is recommended



## Features & Benefits

- Protects the operator from harmful fumes.
- Prevents fumes damaging the laser.
- To further protect the laser the automatic flow control system maintains a constant extraction rate throughout the life of the filter.
- Safely recirculates air so no holes in walls or ceilings are required for external ducting.
- Low capital and running costs with minimal installation required.
- Patented Labyrinth™ pre filter protects the HEPA filter and delivers vastly extended filter life.
- Submicronic HEPA particle filtration - 99.997% of particles captured at 0.3 micron.
- Specially formulated carbon layer filters gas from the process.
- All filters deliver excellent filter life.
- Filters can be changed in seconds.
- Digital Control System with Graphic Display.
- Gas and Particle sensors.
- Easy to move around on castors.

## Specification

Voltage	230V ±10%	120V ±10%
Part number	080620DE	080625DE
Wattage	2.4 kW	2.2 kW
Sound rating	65 dBA	65 dBA
Max flowrate	800 m³/hr	471 cf/m
Frequency	50 Hz / 60 Hz	
Cabinet height (inc. castors)	1150 mm • 45 1/4"	
Cabinet width (not inc. hose)	540 mm • 21 1/4"	
Cabinet depth (not inc. hose)	670 mm • 23 1/2"	
Cabinet weight (inc. filters)	80 Kg • 176 lbs	

### Controls

- Graphic Display
- Gas and Particle Sensors
- Filter Blocked Warning
- Motor Run and Temperature Sensors
- Realtime airflow display.

### Construction

All machines are constructed of corrosion resistant stainless steel

### Blowers

Continuously rated, powerful brushless blowers

## Connection Kit

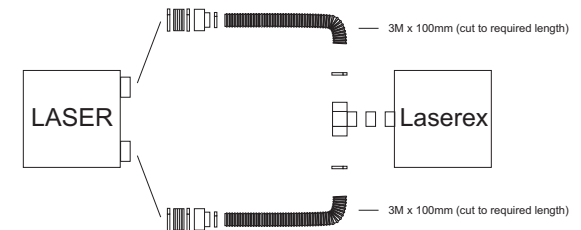

Code: 120294

1	100mm female coupling	4	135-135mm hose clips
1	100mm equal tee		
2	3M x 100mm flexible hose		
4	90mm to 120mm hose clips		
2	150-100mm reducers		
2	0.25m x 150mm flexible hose		

Metal Kits Available. Contact Purex for Details

# LasereX 800i 3-Tier

Built for

All Epilog Lasers (Except 36EXT 60W)\*

The 800i 3-Tier is a heavy duty machine and is used where large volumes of gas are produced i.e. lasing acrylic.

## Machines



**Voltage: 230V**  
Code: 080630DE

**Voltage: 120V**  
Code: 080635DE

Supplied with: 2 x Main Filters + 1 x Labyrinth Pre-Filter

## Options



**HEPA Filter**  
Code: 113650

**Chemical Filter**  
Code: 113651



**Labyrinth™ pre-filter F8/F9**  
Code: 111101

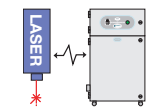

**Laser Interfacing Pack:**  
Code: 100269



A spare filter set is recommended

## Features & Benefits

- Protects the operator from harmful fumes.
- Prevents fumes damaging the laser.
- To further protect the laser the automatic flow control system maintains a constant extraction rate throughout the life of the filter.
- Safely recirculates air so no holes in walls or ceilings are required for external ducting.
- Low capital and running costs with minimal installation required.
- Patented Labyrinth™ pre filter protects the HEPA filter and delivers vastly extended filter life.
- Submicronic HEPA particle filtration - 99.997% of particles captured at 0.3 micron.
- Specially formulated carbon layer filters gas from the process.
- All filters deliver excellent filter life.
- Filters can be changed in seconds.
- Digital Control System with Graphic Display.
- Gas and Particle sensors.
- Easy to move around on castors.

## Specification

Voltage	230V ±10%	120V ±10%
Part number	080630DE	080635DE
Wattage	2.4 kW	2.2 kW
Sound rating	65 dBA	65 dBA
Max flowrate	800 m³/hr	471 cf/m
Frequency	50 Hz / 60 Hz	
Cabinet height (inc. castors)	1150 mm • 45 1/4"	
Cabinet width (not inc. hose)	540 mm • 21 1/4"	
Cabinet depth (not inc. hose)	670 mm • 23 1/2"	
Cabinet weight (inc. filters)	80 Kg • 176 lbs	

### Controls

- Graphic Display
- Gas and Particle Sensors
- Filter Blocked Warning
- Motor Run and Temperature Sensors
- Realtime airflow display.

### Construction

All machines are constructed of corrosion resistant stainless steel

### Blowers

Continuously rated, powerful brushless blowers

## Connection Kit

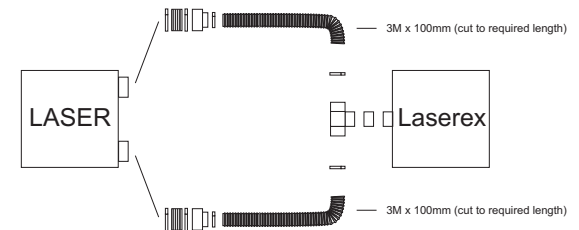

Code: 120294

1	100mm female coupling	4	135-135mm hose clips
1	100mm equal tee		
2	3M x 100mm flexible hose		
4	90mm to 120mm hose clips		
2	150-100mm reducers		
2	0.25m x 150mm flexible hose		

Metal Kits Available. Contact Purex for Details

# Laserex 1500i

Built for

36EXT 60W\*

The 1500i is a heavy duty machine and is used where extra airflow is required for one or more lasers or where the work burden is high.



### Machines



<b>Voltage: 230V</b> Code: 0LX1512DE
<b>Voltage: 120V</b> Code: 0LX1513DE

**Supplied with:** 1 x Main Filter + 1 x Labyrinth Pre-Filter

### Options

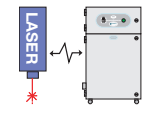
	<b>HEPA / Twin Chemical Filter</b> Code: 110614
	<b>Labyrinth™ pre-filter F8/F9</b> Code: 111099
	<b>Laser Interfacing Pack:</b> Code: 100269

A spare filter set is recommended



**NB:** This machine is supplied without a plug and therefore must be hard wired to the mains electrical supply by a qualified person.

### Features & Benefits

- Protects the operator from harmful fumes.
- Prevents fumes damaging the laser.
- To further protect the laser the automatic flow control system maintains a constant extraction rate throughout the life of the filter.
- Safely recirculates air so no holes in walls or ceilings are required for external ducting.
- Low capital and running costs with minimal installation required.
- Patented Labyrinth™ pre filter protects the HEPA filter and delivers vastly extended filter life.
- Submicronic HEPA particle filtration - 99.997% of particles captured at 0.3 micron.
- Specially formulated carbon layer filters gas from the process.
- All filters deliver excellent filter life.
- Filters can be changed in seconds.
- Digital Control System with Graphic Display.
- Gas and Particle sensors.
- Easy to move around on castors.

### Specification

Voltage	230V ±10%	120V ±10%
Part number	0LX1512DE	0LX1513DE
Wattage	1.5 kW	1.5 kW
Sound rating	59 dBA	59 dBA
Max flowrate	1700 m <sup>3</sup> /hr	1000 cf/m
Frequency	50 Hz / 60 Hz	
Cabinet height (inc. castors)	1400 mm • 55 1/8"	
Cabinet width (not inc. hose)	690 mm • 27 1/4"	
Cabinet depth (not inc. hose)	710 mm • 28"	
Cabinet weight (inc. filters)	134 Kg • 296 lbs	

#### Controls

- Graphic Display
- Gas and Particle Sensors
- Filter Blocked Warning
- Motor Run and Temperature Sensors
- Realtime airflow display.

#### Construction

All machines are constructed of corrosion resistant stainless steel

#### Blowers

Continuously rated, powerful brushless blowers

### Connection Kit

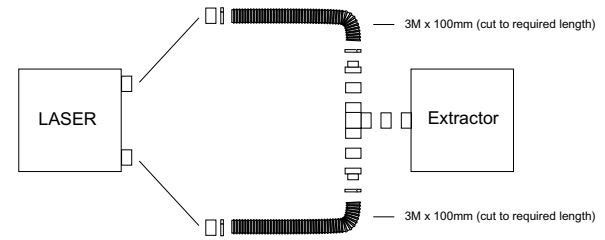

Code: 120287

1	150mm female coupling	2	90mm-120mm hose clips
1	150mm equal tee	2	100mm female coupling
2	150mm female coupling		
2	150mm-100mm reducer		
2	90mm-120mm hose clips		
2	3M x 100mm flexible hose		

Metal Kits Available. Contact Purex for Details



Distributed by:

